

Grooved Adaptor Flange

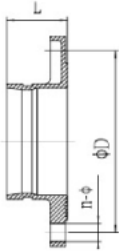

Nominal size mm/in	Pipe O.D mm/in	Dimension mm/in		PN10		PN16		PN25		ANSI 150		10K		20K		BS	
		L	D	Bolt Size	D	Bolt Size	D	Bolt Size	D	Bolt Size	D	Bolt Size	D	Bolt Size	D	Bolt Size	
25 1	33.7 1.327	60	85	4-M12	85	4-M12	85	4-M12	79.5	4-1/2							
32 1 1/4	42.4 1.66	60	100	4-M16	100	4-M16	100	4-M16	89	4-1/2							
40 1 1/2	48.3 1.9	60	110	4-M16	110	4-M16	110	4-M16	98.5	4-1/2	105	4-5/8	105	4-5/8			
50 2	60.3 2.375	65	125	4-M16	125	4-M16	125	4-M16	120.5	4-5/8	120	4-5/8	120	8-5/8			
65 2 1/2	73 2.875	60	145	4-M16	145	4-M16	145	8-M16	139.5	4-5/8							
65 2 1/2	76.1 3	65	145	4-M16	145	4-M16	145	8-M16	139.5	4-5/8	140	4-5/8	140	8-5/8	127	4-M16	
80 3	88.9 3.5	65	160	8-M16	160	8-M16	160	8-M16	152.5	8-5/8	150	8-5/8	160	8-3/4	146	4-M16	
100 4	108 4.252	65	180	8-M16	180	8-M16	190	8-M20									
100 4	114.3 4.5	70	180	8-M16	180	8-M16	190	8-M20	190.5	8-5/8	175	8-5/8	165	8-3/4	178	8-M16	
125 5	133 5.25	70	210	8-M16	210	8-M16	220	8-M24									
125 5	139.7 5.5	70	210	8-M16	210	8-M16	220	8-M24	216	8-3/4	210	8-3/4	225	8-7/8	210	8-M16	
125 5	141.3 5.563	70	210	8-M16	210	8-M16			216	8-3/4							
150 6	159 6.26	70	240	8-M20	240	8-M20	250	8-M24									
150 6	165.1 6.5	70	240	8-M20	240	8-M20	250	8-M24	241.5	8-3/4	240	8-3/4	260	12-7/8	235	8-M20	
150 6	168.3 6.625	70	240	8-M20	240	8-M20			241.5	8-3/4							
200 8	216.3 8.516	80									290	12-3/4	305	12-7/8			
200 8	219.1 8.625	80	295	8-M20	295	12-M20	310	12-M24	298.5	8-3/4							292 8-M20
250 10	267.4 10.528	85									355	12-7/8	380	12-1			
250 10	273 10.75	85	350	12-M20	355	12-M20			362	12-7/8							356 12-M20
300 12	318.5 12.539	90									400	12-7/8	430	16-1			
300 12	323.9 12.75	90	400	12-M20	410	12-M20			432	12-7/8							406 12-M22
350 14	355.6 12.750	100							476	12-1							470 12-M22
350 14	377.0 14.843	100			470	16-M20											
400 16	406.4 16.000	110							540	16-1							521 12-M22
400 16	426.0 16.772	110			525	16-M24											
450 18	457.2 18.000	115							578	16-11/8							584 16-M22
450 18	480 18.897	115			585	20-M24											
500 20	508.0 20.000	152			650	20-M24			635	20-11/8							
900 24	909.6 24.000	152			770	20-M27			749.5	20-11/4							

Threaded Flange

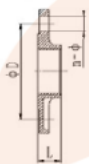

Nominal size mm/in	Pipe O.D mm/in	Dimension mm/in		PN10		PN16		PN25		ANSI 150		10K		20K		BS	
		L	D	D	Bolt Size	D	Bolt Size	D	Bolt Size	D	Bolt Size	D	Bolt Size	D	Bolt Size		
25 1	33.7 1.327	30	85	4-M12	85	4-M12	85	4-M12	79.5	4-1/2							
32 1 1/4	42.4 1.66	30	100	4-M16	100	4-M16	100	4-M16	89	4-1/2							
40 1 1/2	48.3 1.9	30	110	4-M16	110	4-M16	110	4-M16	98.5	4-1/2	105	4-5/8	105	4-5/8			
50 2	60.3 2.375	30	125	4-M16	125	4-M16	125	4-M16	120.5	4-5/8	120	4-5/8	120	8-5/8			
65 2 1/2	73 2.875	35	145	4-M16	145	4-M16	145	8-M16	139.5	4-5/8							
65 2 1/2	76.1 3	35	145	4-M16	145	4-M16	145	8-M16	139.5	4-5/8	140	4-5/8	140	8-5/8	127	4-M16	
80 3	88.9 3.5	35	160	8-M16	160	8-M16	160	8-M16	152.5	8-5/8	150	8-5/8	160	8-3/4	146	4-M16	
100 4	114.3 4.5	40	180	8-M16	180	8-M16	190	8-M20	190.5	8-5/8	175	8-5/8	185	8-3/4	178	8-M16	