

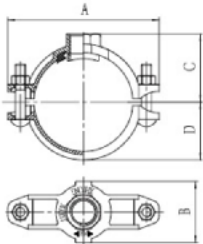

**Threaded Out Let  
Mechanical Tee**



Nominal size mm/in	Pipe O.D mm/in	Working Pressure MPa/psi	Dimension mm				Hole Dia mm/in	Bolt Size
			A	B	C	D		
125*65 5*2 1/2	139.7*76.1 5.5*3	2.07 300	206	114	95	81	80	2-M12*75
125*80 5*3	139.7*88.9 5.5*3.5	2.07 300	206	128	95	81	92	2-M12*75
125*100 5*4	139.7*114.3 5.5*4.5	2.07 300	208	157	117	81	114	2-M12*75
125*25 5*1	141.3*33.7 5.563*1.327	2.07 300	206	72	93	82	38	2-M12*75
125*32 5*1 1/4	141.3*42.4 5.563*1.669	2.07 300	206	83	93	82	46	2-M12*75
125*40 5*1 1/2	141.3*48.3 5.563*1.9	2.07 300	206	85	93	82	53	2-M12*75
125*50 5*2	141.3*60.3 5.563*2.375	2.07 300	206	95	95	82	64	2-M12*75
125*65 5*2 1/2	141.3*73 5.563*2.875	2.07 300	206	114	95	82	80	2-M12*75
125*65 5*2 1/2	141.3*76.1 5.563*3	2.07 300	206	114	95	82	80	2-M12*75
125*80 5*3	141.3*88.9 5.563*3.5	2.07 300	206	128	95	82	92	2-M12*75
125*100 5*4	141.3*114.3 5.563*4.5	2.07 300	208	157	117	82	114	2-M12*75
150*25 6*1	159*33.7 6.25*1.327	2.07 300	228	72	105	90	38	2-M12*75
150*32 6*1 1/4	159*42.4 6.25*1.669	2.07 300	228	83	105	90	46	2-M12*75
150*40 6*1 1/2	159*48.3 6.25*1.9	2.07 300	228	85	105	90	53	2-M12*75
150*50 6*2	159*60.3 6.25*2.375	2.07 300	228	95	108	90	64	2-M12*75
150*65 6*2 1/2	159*76.1 6.25*3	2.07 300	228	115	108	90	80	2-M12*75
150*80 6*3	159*88.9 6.25*3.5	2.07 300	228	128	108	90	92	2-M12*75
150*100 6*4	159*114.3 6.25*4.5	2.07 300	228	158	117	90	114	2-M12*75
150*15 6* 1/2	165*21.3 6.5*0.84	2.07 300	242	72	105	93	38	2-M14*75
150*20 6* 3/4	165*26.7 6.5*1.05	2.07 300	242	72	105	93	38	2-M14*75
150*25 6*1	165*33.7 6.5*1.327	2.07 300	242	72	105	93	38	2-M14*75
150*32 6*1 1/4	165*42.4 6.5*1.669	2.07 300	242	83	105	93	46	2-M14*75
150*40 6*1 1/2	165*48.3 6.5*1.9	2.07 300	242	85	105	93	53	2-M14*75
150*50 6*2	165*60.3 6.5*2.375	2.07 300	242	95	108	93	64	2-M14*75
150*65 6*2 1/2	165*76.1 6.5*3	2.07 300	242	115	108	93	80	2-M14*75

Nominal size mm/in	Pipe O.D mm/in	Working Pressure MPa/psi	Dimension mm				Hole Dia mm/in	Bolt Size
			A	B	C	D		
150*80 6*3	165.1*88.9 6.5*3.5	2.07 300	242	128	108	93	92	2-M14*75
150*100 6*4	165.1*114.3 6.5*4.5	2.07 300	242	158	112	93	114	2-M14*75
150*15 6* 1/2	168.3*21.3 6.625*0.84	2.07 300	248	72	109	96	38	2-M14*75
150*20 6* 3/4	168.3*26.7 6.625*1.05	2.07 300	248	72	109	96	38	2-M14*75
150*25 6*1	168.3*33.7 6.625*1.327	2.07 300	248	72	111	96	38	2-M14*75
150*32 6*1 1/4	168.3*42.4 6.625*1.669	2.07 300	248	83	111	96	46	2-M14*75
150*40 6*1 1/2	168.3*48.3 6.625*1.9	2.07 300	248	85	111	96	53	2-M14*75
150*50 6*2	168.3*60.3 6.625*2.375	2.07 300	248	95	111	96	64	2-M14*75
150*65 6*2 1/2	168.3*73 6.625*2.875	2.07 300	248	115	111	96	80	2-M14*75
150*65 6*2 1/2	168.3*76.1 6.625*3	2.07 300	248	115	111	96	80	2-M14*75
150*80 6*3	168.3*88.9 6.625*3.5	2.07 300	248	128	111	96	92	2-M14*75
150*100 6*4	168.3*114.3 6.625*4.5	2.07 300	248	158	116	96	114	2-M14*75
200*25 8*1	219*33.7 8.625*1.327	2.07 300	298	75	134	122	38	2-M16*85
200*32 8*1 1/4	219*42.4 8.625*1.669	2.07 300	298	82	137	122	46	2-M16*85
200*40 8*1 1/2	219*48.3 8.625*1.9	2.07 300	298	86	137	122	53	2-M16*85
200*50 8*2	219*60.3 8.625*2.375	2.07 300	298	98	137	122	64	2-M16*85
200*65 8*2 1/2	219*73 8.625*2.875	2.07 300	298	115	137	122	80	2-M16*85
200*65 8*2 1/2	219*76.1 8.625*3	2.07 300	298	115	137	122	80	2-M16*85
200*80 8*3	219*88.9 8.625*3.5	2.07 300	298	128	139	122	92	2-M16*85
200*100 8*4	219*114.3 8.625*4.5	2.07 300	298	156	154	122	114	2-M16*85
250*50 10*2	273*60 10.75*2.375	2.07 300	372	100	168	151	64	2-M20*110
250*65 10*2 1/2	273*73 10.75*2.875	2.07 300	372	115	168	151	80	2-M20*110
250*65 10*2 1/2	273*76 10.75*3	2.07 300	372	115	168	151	80	2-M20*110
250*65 10*3	273*89 10.75*3.5	2.07 300	372	128	169	151	92	2-M20*110
250*65 10*4	273*114 10.75*4.5	2.07 300	372	160	182	151	114	2-M20*110